



LINEAR VARIABLE DISPLACEMENT TRANSDUCERS PJx series.

Transducers of this type are a group of AC/AC transducers (sensors) based on differential transformer principle. AC/AC group means without electronic components inside. They are used to measure: position, displacement, movement, distance, height, length etc. The main application of this type is to measure deflecting moving and displacement of machines' details.

CHARAKTERISTIC

- Compact construction
- Harsh environment application
- High accuracy
- High reliability

CONSTRUCTION

The basic element of this sensors is a differential transformer placed inside a cylindrical enclosure. Inside the transformer there is a magnetic core. The core's position affects the output signal amplitude converting displacement to electric signal.

TECHNICAL DATA

Type	PJx20	PJx30	PJx50	PJx100	PJx150	PJx200	PJx300	PJx400	PJx500
Measure range [mm]	±10	±15	±25	±50	±75	±100	±150	±200	±250
A [mm]	97	117	147	247	265	361	491	591	700
B [mm]	140	165	200	290	320	455	565	665	705

1	Excitation	2Vrms, 5÷15 mA, 5 kHz (for PJx500 1kHz)
2	Output signal	1Vrms ±10% (for PJx500 2Vrms)
3	Loading resistance.	R ≥ 51 kΩ
4	Isolation resistance.	≥ 20 MΩ
5	Accuracy [%] MR	<ul style="list-style-type: none"> • ≤ 0,5 • ≤ 0,25 • ≤ 0,1
6	Temperature range	<ul style="list-style-type: none"> • -20...+80°C; • -20...+120°C • -20...+200°C
7	Temperature range	0,02% / °C
8	Electrical connection	cable - LIYCY 4x0,14, 1/2 m, no connector
9	Vibration	20 g to 2 kHz (for PJx20, PJx30, PJx50, PJx100)
10	Surge	100 g, 11 ms (for PJx20, PJx30, PJx50, PJx100)
11	Material	AISI 304 steel

SCHEMATIC DIAGRAM

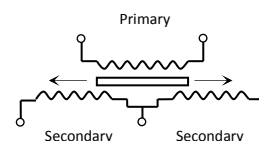

DIMENSIONS

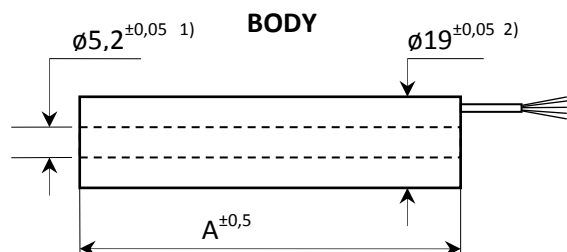

1) for PJx500 $\varnothing 6,5^{\pm 0,05}$

2) for PJx500 $\varnothing 20^{\pm 0,05}$

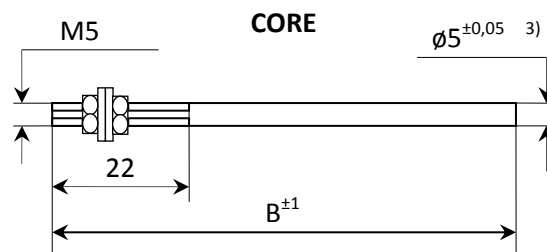

3) dla PJx500 $\varnothing 6^{\pm 0,05}$

Peltron Towarzystwo Produkcyjno Handlowe Sp. z o.o.

ul. Turystyczna 4, 05-462 Wiązowna

tel. +48 (22) 615-63-56 fax: +48 (22) 615-70-78 email: peltron@home.pl